

Troubleshooting

Flowchart — Both Fans

Both fans do not run at all.

Check the No. 15 (7.5A) fuse in the under-dash fuse/relay box and the No. 50 (20A) fuse in the under-hood fuse/relay box.

Are the fuses OK?

NO

Replace the fuses.

YES

Remove the condenser fan relay in the under-hood relay box A.

Test the condenser fan relay (see page 21-66).

Is the relay OK?

NO

Replace the condenser fan relay

YES

Measure voltage between the No. ① terminal (+) and body ground (-).

Is there battery voltage?

NO

Repair open in the WHT wire between the No. 50 (20A) fuse in the under-hood fuse/relay box and the condenser fan relay.

YES

To page 22-45

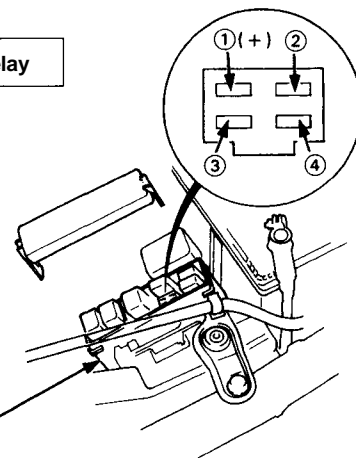
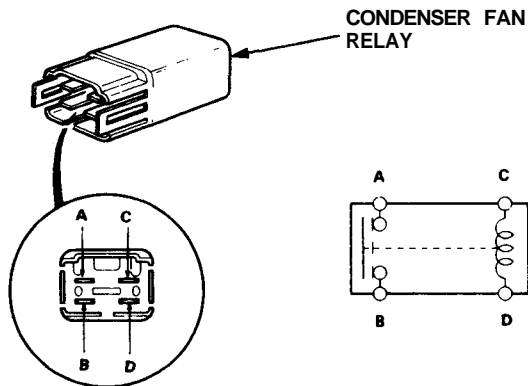

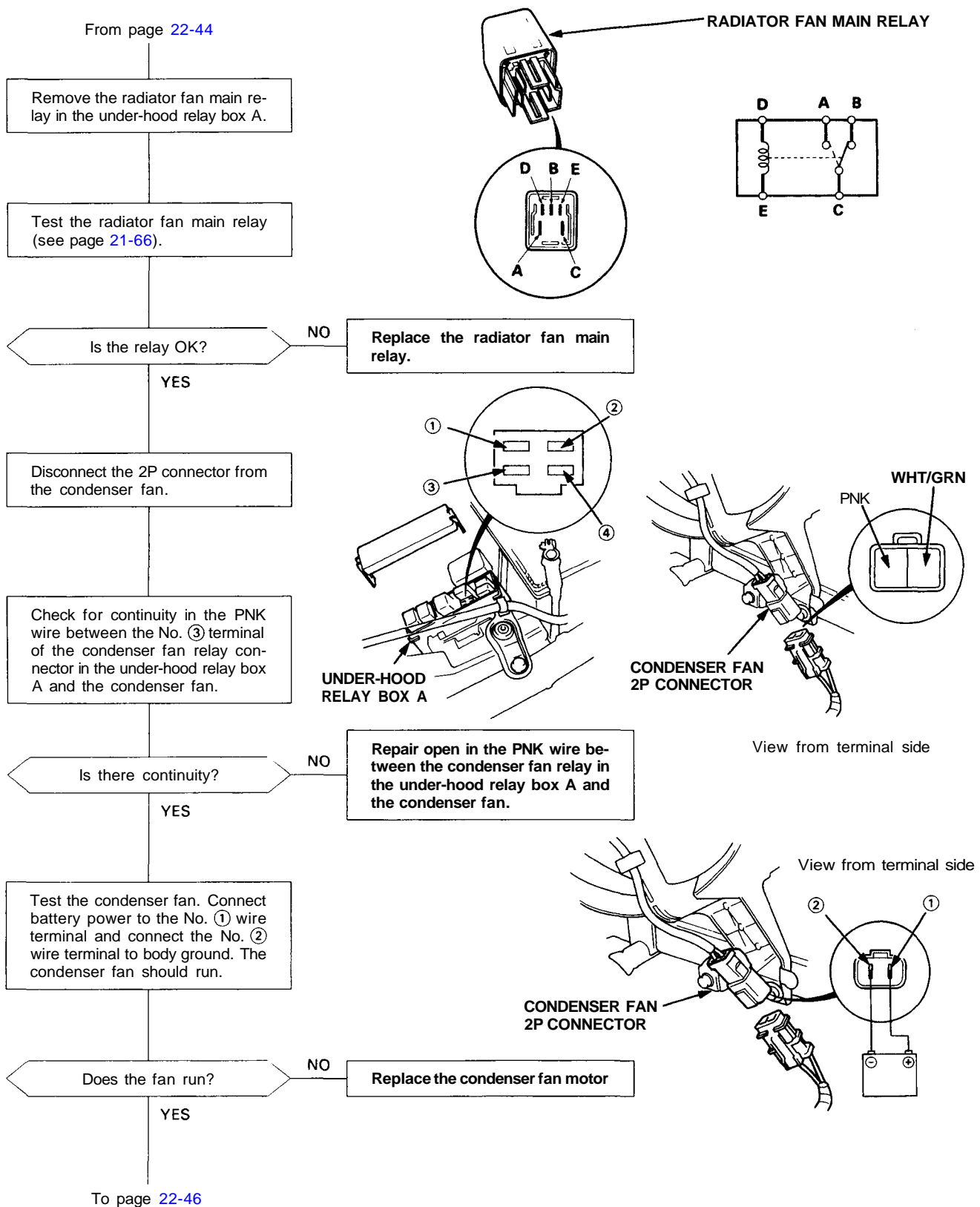

(cont'd)

Troubleshooting

Flowchart — Both Fans (cont'd)

From page 22-45

Check for continuity in the WHT/GRN wire between the No. ② terminal of the radiator fan main relay connector in the under-hood relay box A and the condenser fan.

Is there continuity?

NO

Repair open in the WHT/GRN wire between the radiator fan main relay in the under-hood relay box A and the condenser fan.

YES

Disconnect the 2P connector from the radiator fan.

Check for continuity in the WHT/BLU wire between the No. ④ terminal and the radiator fan.

Is there continuity?

NO

Repair open in the WHT/BLU wire between the radiator fan main relay in the under-hood relay box A and the radiator fan.

YES

Test the radiator fan. Connect battery power to the No. ① wire terminal and the No. ② wire terminal to body ground. The radiator fan should run.

Does the fan run?

NO

Replace the radiator fan motor.

YES

To page 22-47

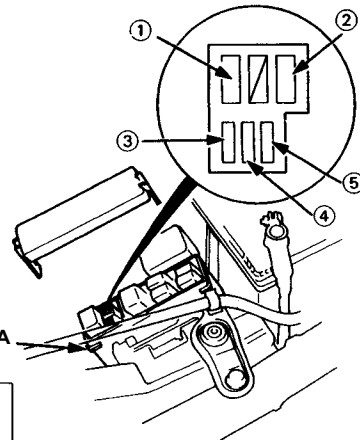

RADIATOR FAN 2P CONNECTOR

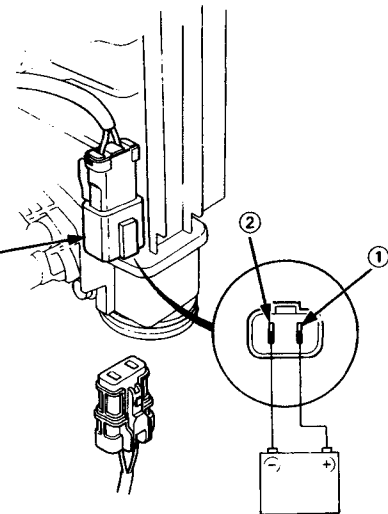

View from terminal side



From page 22-46

Check for continuity in the BLK wire between the radiator fan and body ground.

Is there continuity?

NO

Check for an open in the BLK wire between the radiator fan and body ground. If the wire is OK, check for a poor ground at G152.

YES

Disconnect the 8P connector from the radiator fan control module.

Check for the continuity in the BLK wire between the radiator fan control module and body ground.

Is there continuity?

NO

Check for an open in the BLK wire between the radiator fan control module and body ground. If the wire is OK, check for a poor ground at G301, G302 and G303.

YES

Measure voltage between the YEL/BLU wire terminal (+) and body ground (-).

Is there battery voltage?

NO

Repair open in the YEL/BLU wire between the No. 15 (7.5A) fuse in the under-hood relay box A and the radiator fan control module.

YES

To page 22-48

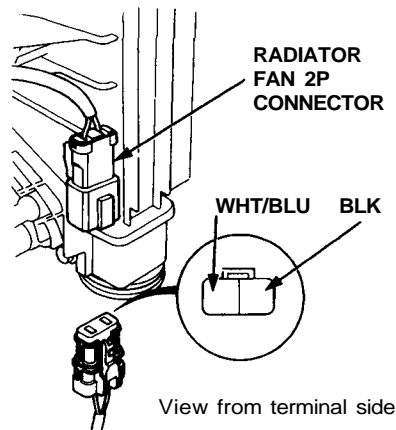

RADIATOR FAN 2P CONNECTOR

RADIATOR FAN CONTROL MODULE

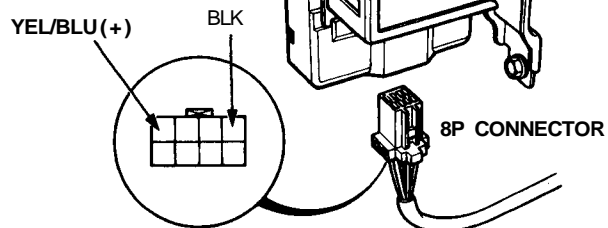

8P CONNECTOR

(cont'd)

Troubleshooting

Flowchart — Both Fans (cont'd)

From page 22-47

Check for continuity in the BLU/RED wire between the radiator fan control module and body ground.

Is there continuity?

YES

Repair short in the BLU/RED wire between the radiator fan control module and the condenser fan relay in the under-hood relay box A.

NO

Using jumper wire connect the No. ④ terminal of the condenser fan relay connector in the under-hood relay box A to body ground.

Check for continuity in the BLU/RED wire between the radiator fan control module and body ground.

Is there continuity?

NO

Repair open in the BLU/RED wire between the radiator fan control module and the condenser fan relay in the under-hood relay box A.

YES

Check for continuity in the wire between the No. ② terminal of the condenser fan relay connector in the under-hood relay box A and the radiator fan control module.

Is there continuity?

NO

Repair open in the GRN wire between the condenser fan relay in the under-hood relay box A and the radiator fan control module.

YES

To page 22-49

RADIATOR FAN CONTROL MODULE

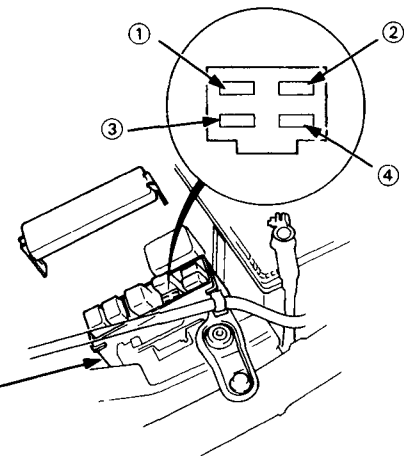
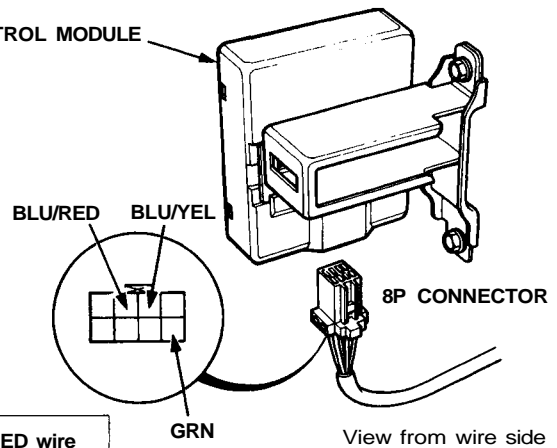



From page 22-48

